

Owner's cabin alternative

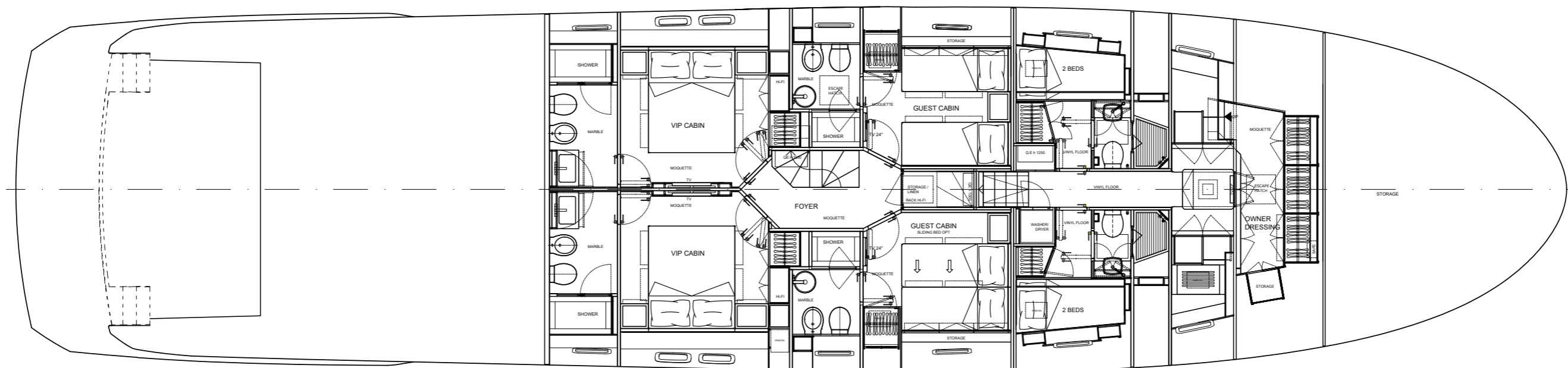

OPTIONAL: 4-cabin version

Length overall	29,06 m	
Maximum beam	6,76 m	
Construction height	3,25 m	
Displacement @ half load *	100 t	
Displacement @ full load *	110 t	
Waterline length @ half load	23,12 m	
Waterline length @ full load	23,18 m	
Draught @ half load	1,92 m	
Draught @ full load	1,98 m	
Guest accommodation	8 people	
Crew accommodation	4 people	
Engine	a) 2 x MTU 12V2000M96L - 1947 HP	b) 2 x MTU 16V2000M86 - 2216 HP
Consumption (approx) **	a) 2 x 350 l/h @ 2200 rpm	b) 2 x 360 l/h @ 2200 rpm
Power output @ 100% MCR	a) 2 x 1432 kW @ 2450 rpm	b) 2 x 1630 kW @ 2450 rpm
Gearbox	a) ZF3060V, R= 3:1	b) ZF3060V, R= 3:1
Transmission	V-drive	
Propeller	In Nibral in class "S"	
Shafts	In Aquamet 17 or equivalent	
Gensets	1 x 35 kW + 1 x 45 kW	
Rudders	AISI316 stainless steel	
Maximum speed (approx) ***	a) 26 kn	b) 28 kn
Cruising speed (approx.) ***	a) 23 kn	b) 24 kn
Economical speed (approx)	10 kn	
Max range @ economical speed (approx)	1250 nm	
Deadrise	16°	
A/C power	188000 btu/h	
Fuel capacity	10350 l	
Fresh water capacity	1500 l	
Black water capacity	560 l	
Grey water capacity	760 l	
Tender length	max 4,5 m	
Tender weight	max 700 kg	

* Displacement data refers to a yacht with standard layout as described in the sales specification

** Main engine performance data and characteristics are derived from the manufacturer's specification

*** Speed data refer to a yacht with standard layout as described in the sales specification, considering a third of liquid weight, a third of luggage weight (25kg per bed) and 5 crew members (80kg each), and without stabilization system and hardtop

It's not an investment if it's destroying the planet



INFUSION LAYUP SYSTEM

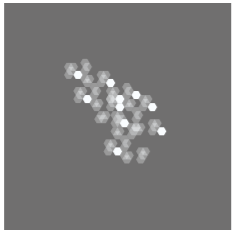

BIO RESIN & CORE



FSC CERTIFIED WOOD SUPPLY



FORMALDEHYDE FREE FURNITURE

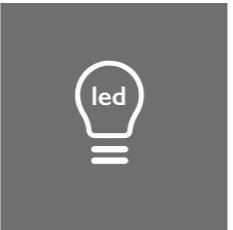

LED LIGHTING



BIOCHROME®



SUSTAINABLE LEATHER



CLASS A++

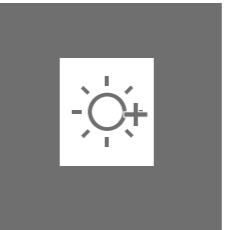

SOLAR PANELS



HULL EFFICIENCY



THERMAL INSULATION