



# C50



## TECHNICAL DATA

C50

LOA	15,55 m	51'1"
Hull length	14,99 m	49'2"
LWL	14,44 m	47'4"
Beam max.	5,00m	16'4"
Standard draft	2,30 m	7'7"
Shallow draft	1,85 m	6'1"
Ballast	4.301 / 4.425 kg	9.482 / 9.755 lbs
Displacement	15.490 kg	26.312 lbs
Engine std	58,8 kW / 80 hp	58,8 kW / 80 hp
Fuel tank [approx.]	250 L	66 gal
Water tank [approx.]	650 L	143 gal
Sail area	135 m <sup>2</sup>	1.453 sq ft
Mainsail std	76 m <sup>2</sup>	818 sq ft
Mainsail furling	73 m <sup>2</sup>	785 sq ft
Genoa	59 m <sup>2</sup>	635 sq ft
Gennaker	195 m <sup>2</sup>	2.098 sq ft
Code 0	115 m <sup>2</sup>	1.237 sq ft
Mast height above WL	23,25 m	76'4" ft
I	20,00 m	65'6" ft
J	5,77 m	18' ft
P	19,15 m	62'10" ft
E	6,66 m	21'10" ft
CE category	A	A
Design	Cossutti Yacht Design	Cossutti Yacht Design

TRIM LEVEL	BASE PRICE EX WORKS EXCL. VAT
HOLIDAY	284.000 €
STYLE	296.500 €

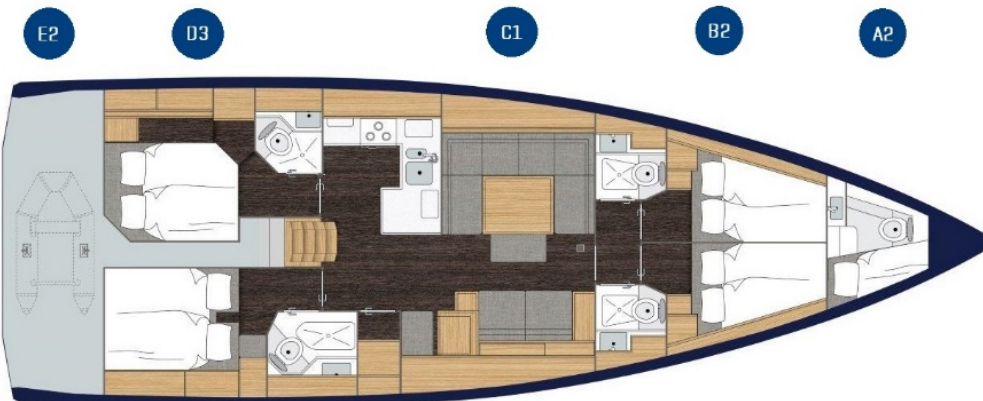
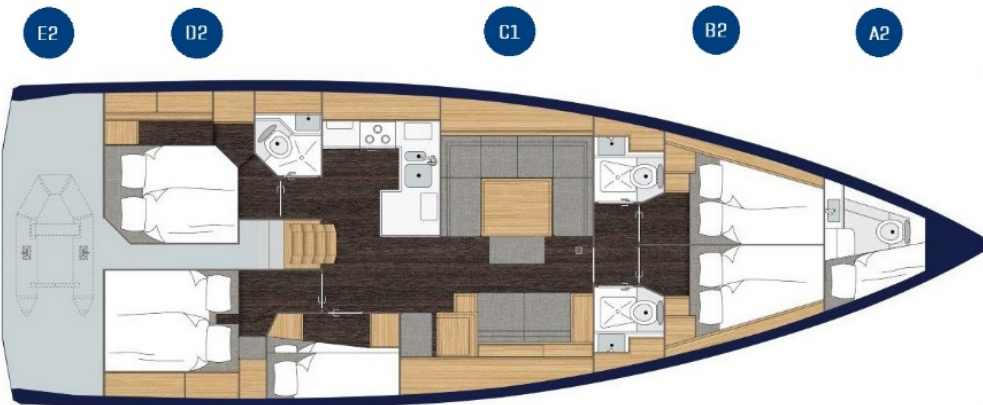
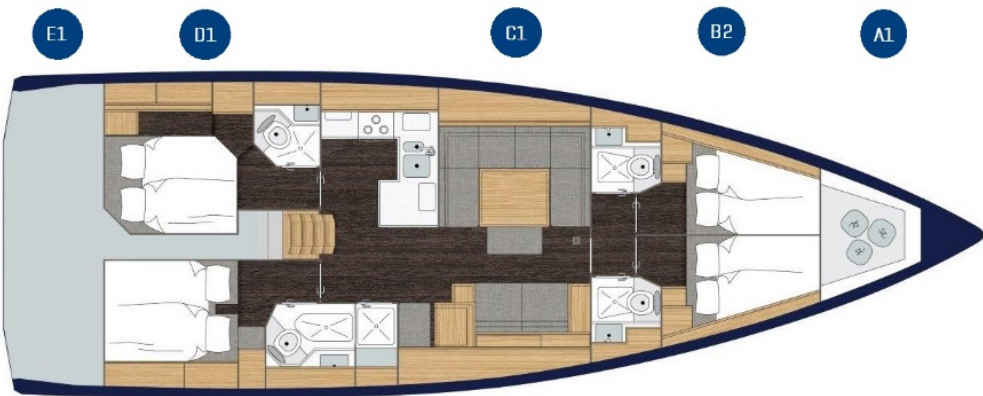
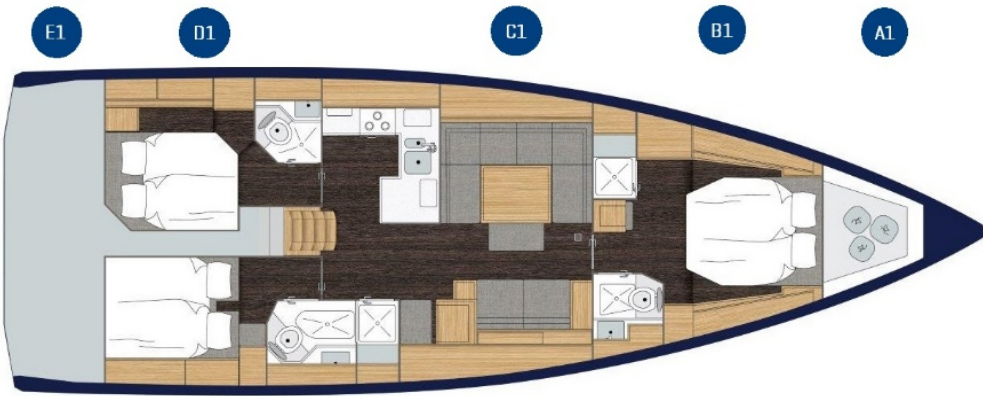

**Hull**

Hull in sandwich construction

**Keel**

L-shaped keel, cast iron, draft 2,30 m

**Steering System**

Twin wheel steering system  
Single rudder

**Propulsion**

Diesel engine, 59 kW / 80 hp, sail drive  
Mechanical throttle, mounted on steering pedestal, starboard  
3 blade fixed propeller

**Interior Layout**

A1: Sail locker  
B1: Queen size "island" double berth, storage, separate head and shower stall  
C1: Salon incl. L shaped galley, dining area on port, lounge area and chart table on stb  
D3: 2 twin cabins aft incl. head on port and utility room on stb  
E1: Storage space for toys and equipment under cockpit, access via cockpit floor hatch

**Interior Styling**

"Classic" Mahogany interior, incl. "Elm" floor  
Laminate worktop surface in galley "brown stone"

**Upholstery**

Upholstery "Vela" in salon  
Standard mattresses for all berths

**Interior Equipment**

Fridge in galley, 110L, top loading  
3 burner stove with oven  
Salon dining table

**Plumbing System**

40 L boiler  
70 L holding tank, per toilet  
Electric and manual bilge pump

**Electrical Systems**

1 x engine battery, 12 V / 95 Ah, AGM  
2 x service batteries, 12 V / 2 x 95 Ah, AGM  
Battery charger, 40 Ah [3 channels]  
230 V socket in each cabin  
Country version EU

**Cockpit & Deck**

Deck in sandwich construction, cockpit floor, side decks and coach roof with non-slip structure  
Bathing platform, electric  
Teak on cockpit benches and bathing platform  
Companion way with washboard and sliding hatch in acrylic glass, lockable  
Twin cockpit tables  
Flush hatches  
Stainless steel steering wheels with leather cover

**Mooring & Anchoring**

Stainless steel anchor arm with roller, fixed  
4 mooring cleats, stainless steel, fixed

**Standing & Running Gear**

Sportmast deck stepped 2 spreader, aluminium  
Above deck jib furler, manual  
Rodkicker  
Backstay adjuster, mechanical  
Midboom sheeting system  
Elvström Cruisetech Dacron mainsail & self-tacking jib

**Winches**

2 x halyard winches, size 55, manual

## TRIM LEVEL EQUIPMENT

	HOLIDAY	STYLE	C50
<b>Hull</b>			
Hull colour signal white with dark blue cove- and waterline	■		
Hull colour signal white with silk grey cove- and waterline		■	
<b>Interior Styling</b>			
Upholstered headboard in front cabin [B1]		■	
Upholstered bed frames in front and aft cabins		■	
Fabric covered ceiling panels in salon		■	
Leather style covered chart table		■	
Leather style covered handrails		■	
<b>Cockpit &amp; Deck</b>			
Rope storage boxes, at helm position		■	
<b>Interior Equipment</b>			
Reading lights incl. USB charger, salon and cabins		■	
Handrail on ceiling in stainless steel with leather cover		■	
<b>Electrical Systems</b>			
7" Digital Switching System incl. multifunction display at chart table with GPS function	■		
9" Digital Switching System incl. multifunction display at chart table with GPS function		■	

## SAIL READY PACKAGES

	HOLIDAY	STYLE	Price excl. VAT	C50
<b>SAIL READY PACK "HOLIDAY" [HP]</b>	○	—	13.500 €	□
2 Additional service batteries, 12 V / 2 x 95 Ah, AGM				
Guard rail exit, both sides				
Anchor windlass, electrical				
"Delta" Anchor, 25 kg, incl. Chain [10 mm, 50 m], galvanized				
Courtesy lights in salon				
Curtains for coachroof and hull windows				
Blinds incl. mosquito nets for hatches in salon and cabins				
2 vents on deck hatches				
LED lights in salon and cabins				
Mooring kit [8 fenders and 4 mooring lines]				
Reading lights incl. USB charger, salon and cabins				
Handrail on ceiling in stainless steel				
Rope storage boxes, at helm position				
Stainless steel bow protection				
<b>UPGRADES SAIL READY PACK "HOLIDAY" [HP]</b>				
Tunnel bow thruster incl. 2 x 95 Ah battery	○	—	6.900 €	□

SAIL READY PACKAGES	HOLIDAY	STYLE	Price excl. VAT	C50
<b>SAIL READY PACK "STYLE" [SP]</b>	—	○	21.590 €	<input type="checkbox"/>
Tunnel bow thruster incl. 2 x 95 Ah battery				
Teak on cockpit bottom				
2 Additional service batteries, 12 V / 2 x 95 Ah, AGM				
Guard rail exit, both sides				
Anchor windlass, electrical				
"Delta" Anchor, 25 kg, incl. Chain (10 mm, 50 m), galvanized				
Courtesy lights in salon and in cockpit				
Curtains for coachroof and hull windows				
Blinds incl. mosquito nets for hatches in salon and cabins				
2 vents on deck hatches				
LED lights in salon and cabins				
Mooring kit (8 fenders and 4 mooring lines)				
Ambient lights in salon and cabins, dimmable				
Extractor hood in galley				
<b>UPGRADES SAIL READY PACK "STYLE" [SP]</b>				
Bow thruster incl. 2 x 95 Ah battery, retractable (Upgrade to bow thruster tunnel)	—	○	5.800 €	<input type="checkbox"/>

ENTERTAINMENT PACKAGES	HOLIDAY	STYLE	Price excl. VAT	C50
<b>ENTERTAINMENT PACKAGE</b>	○	○	1.950 €	<input type="checkbox"/>
Fusion entertainment system with integrated DVD player including Bluetooth streaming, Multi-Zone technology at chart table				
2 x Fusion high end speakers in salon				
2 x Fusion high end speakers in cockpit, watertight				
Fusion MS-NRX 300i remote control in cockpit				
Fusion wireless link				
<b>UPGRADES ENTERTAINMENT PACKAGES</b>				
Fusion MS-RA 205 unit incl. 2x Fusion high end speakers in owner's cabin (B1 only)	—	○	950 €	<input type="checkbox"/>
TV preparation in salon incl. lifting mechanism	○	○	1.750 €	<input type="checkbox"/>
40" flat TV incl. lifting mechanism, antenna and cabling in salon	○	○	3.050 €	<input type="checkbox"/>
22" flat TV incl. bracket and cabling in forward cabin (only for B1 layout)	○	○	1.720 €	<input type="checkbox"/>

ELECTRONIC NAVIGATION PACKAGES	HOLIDAY	STYLE	Price excl. VAT	C50
<b>NAVIGATION "BASIC" PACKAGE</b>	○	—	5.600 €	<input type="checkbox"/>
2 x B&G Triton <sup>2</sup> digital displays (one per helm station)				
B&G Zeus <sup>3</sup> 7" chart plotter at stb helm station				
B&G V60 VHF radio and AIS receiver at chart table incl. cabling and antenna				
<b>NAVIGATION "ADVANCED" PACKAGE</b>	○	○	13.250 €	<input type="checkbox"/>
2 x Instrument console (one per helm station)				
2 x B&G Triton <sup>2</sup> digital displays (one per helm station)				
2 x B&G Zeus <sup>3</sup> 9" chart plotter (one per helm station)				
B&G V60 VHF radio and AIS receiver at chart table incl. cabling and antenna				
B&G H60 wireless remote handset				
B&G Autopilot				
B&G Autopilot control unit (at stb helm station)				
B&G WR10 wireless remote control for autopilot				
<b>NAVIGATION "PREMIUM" PACKAGE</b>	—	○	21.250 €	<input type="checkbox"/>
2 x Instrument console (one per helm station)				
2 x B&G H5000 graphic displays (one per helm station)				
2 x B&G Zeus <sup>3</sup> 12" chart plotter (one per helm station)				
B&G V60 VHF radio and AIS receiver at chart table incl. cabling and antenna				
B&G H60 wireless remote handset				
B&G Autopilot				
2 x B&G H5000 Autopilot control unit (one per helm station)				
B&G H5000 Hydra Computer				
NMEA engine information interface for chart plotter				
B&G WR10 wireless remote control for autopilot				
GoFree wireless link				
<b>UPGRADES ELECTRONIC NAVIGATION PACKAGES</b>				
B&G 4G radar	○	○	3.250 €	<input type="checkbox"/>
B&G ForwardScan	—	○	1.550 €	<input type="checkbox"/>
NAIS-500 Transponder: B&G AIS Class B Transponder	○	○	1.350 €	<input type="checkbox"/>
NMEA engine information interface for chart plotter (included in Navigation "PREMIUM" Package)	○	○	950 €	<input type="checkbox"/>

INDIVIDUAL OPTIONS	HOLIDAY	STYLE	Price excl. VAT	C50
<b>Hull/Keel</b>				
Hull colour silk grey with white cove- and waterline	○	○	6.500 €	<input type="checkbox"/>
Hull colour signal white with dark blue cove- and waterline	■	○	1.290 €	<input type="checkbox"/>
Hull colour signal white with silk grey cove- and waterline	○	■	1.290 €	<input type="checkbox"/>
L-shaped keel, cast iron, shallow draft 1,85 m	○	○	3.150 €	<input type="checkbox"/>
<b>Propulsion</b>				
3 blade folding propeller	○	○	2.150 €	<input type="checkbox"/>
Stern thruster incl. 2 x 95 Ah battery, retractable (only with bow thruster retractable)	—	○	12.700 €	<input type="checkbox"/>
<b>Interior Layout</b>				
A2: Crew cabin with sink, toilet and storage space	○	○	4.500 €	<input type="checkbox"/>
B2: 2 double cabins with flex bulkhead, incl. Storage and 2 heads	○	○	4.450 €	<input type="checkbox"/>
D1: 2 twin cabins aft incl. head with separate shower stall on stb	○	○	2.150 €	<input type="checkbox"/>
D2: 2 twin cabins aft, incl. bunk bed cabin on stb.	○	○	2.350 €	<input type="checkbox"/>
E2: Dinghy garage with integrated transom bench and storage/wetbar (for wetbar choose option BBQ/watertap)	○	○	3.450 €	<input type="checkbox"/>
Dining table, lowerable, convertible into double berth incl. cushion, electrical	○	○	2.300 €	<input type="checkbox"/>
<b>Interior Styling [according to BAVARIA Style Guide]</b>				
Interior wood colour Mahogany "Classic"	■	■	Standard	<input type="checkbox"/>
Interior wood colour White Oak "Club"	○	○	4.900 €	<input type="checkbox"/>
Interior wood colour Walnut "Elegant"	○	○	5.400 €	<input type="checkbox"/>
Floor "Elm"	■	■	Standard	<input type="checkbox"/>
Floor "Wenge"	○	○	590 €	<input type="checkbox"/>
Floor "Ocean Line"	○	○	990 €	<input type="checkbox"/>
Laminate worktop surface in galley "Pure White stone"	○	—	350 €	<input type="checkbox"/>
Solid worktop surface in galley "Gravel"	—	○	1.990 €	<input type="checkbox"/>
Solid worktop surface in galley "Crispy Milk"	—	○	2.190 €	<input type="checkbox"/>
<b>Upholstery [according to BAVARIA Style Guide]</b>				
Upholstery "Nautilus" in salon	—	○	1.190 €	<input type="checkbox"/>
Upholstery "Opus" in salon, artificial leather	○	○	1.350 €	<input type="checkbox"/>
Upholstery "Savoy" in salon, leather	—	○	5.350 €	<input type="checkbox"/>
Luxury cold foam mattress with memory top incl. box springs for all berths	○	○	3.450 €	<input type="checkbox"/>
<b>Cockpit Upholstery [according to BAVARIA Style Guide]</b>				
Cockpit cushions incl. backrests and 6 scatter cushions	—	○	3.250 €	<input type="checkbox"/>
Cockpit cushions for lowerable tables	—	○	490 €	<input type="checkbox"/>
Cockpit cushions	○	○	1.950 €	<input type="checkbox"/>
Sun bed cushions on coachroof incl. headrest and cup holders	○	○	1.830 €	<input type="checkbox"/>
Sun bed cushions on foredeck incl. headrest and cup holders	○	○	1.920 €	<input type="checkbox"/>
<b>Deck Flooring</b>				
Teak on cockpit bottom	○	○	4.200 €	<input type="checkbox"/> SP
Teak on side decks	○	○	15.850 €	<input type="checkbox"/>
Teak on coachroof	—	○	5.900 €	<input type="checkbox"/>
Esthec on cockpit benches and bathing platform instead of teak	○	○	590 €	<input type="checkbox"/>
Esthec on cockpit bottom	○	○	4.850 €	<input type="checkbox"/>
Esthec on cockpit bottom instead of teak as an upgrade to SAIL READY PACKS "STYLE"	○	○	680 €	<input type="checkbox"/>
Esthec on side decks	○	○	16.350 €	<input type="checkbox"/>
Esthec on coachroof	—	○	6.250 €	<input type="checkbox"/>
<b>Cockpit &amp; Deck</b>				
GRP steering wheels, black or white	○	○	1.650 €	<input type="checkbox"/>
2 lowerable cockpit tables convertible in sun bathing area, electric	—	○	3.950 €	<input type="checkbox"/>
Drawer fridge incl. compressor at wet bar, 20 L (only in combination with E2 and BBQ)	○	○	1.250 €	<input type="checkbox"/>
BBQ (gas) with sink and water tap in wet bar (only in combination with E2)	○	○	2.300 €	<input type="checkbox"/>
Guard rail exit, both sides	○	○	1.150 €	<input type="checkbox"/> HP, SP
<b>Hoods [according to BAVARIA Style Guide]</b>				
Bimini top	○	○	4.150 €	<input type="checkbox"/>
Sprayhood with handhold	○	○	2.390 €	<input type="checkbox"/>
<b>Tender &amp; Toys</b>				
12 V air compressor at transom for dinghy or toys (only with E2 Layout)	○	○	810 €	<input type="checkbox"/>
<b>Mooring &amp; Anchoring</b>				
6 mooring cleats, aluminum, retractable	—	○	3.100 €	<input type="checkbox"/>
2 mooring cleats midship, stainless steel, fixed	○	○	250 €	<input type="checkbox"/>
Stainless steel bow protection	○	○	490 €	<input type="checkbox"/> HP
"Delta" Anchor, 25 kg, incl. Chain [10 mm, 50 m] stainless steel, as upgrade to SAIL READY PACK "HOLIDAY" and "STYLE"	○	○	3.650 €	<input type="checkbox"/>
Anchor windlass with capstans, electrical, as upgrade to SAIL READY PACK "HOLIDAY" and "STYLE"	○	○	1.190 €	<input type="checkbox"/>
Teak rubrail incl. stainless steel rail	○	○	4.750 €	<input type="checkbox"/>
<b>Standing &amp; Running Gear</b>				
Carbon performance mast, boom and spreaders incl. rod rigging	—	○	on request	<input type="checkbox"/>
Mainsail furling system incl. upgrade to furling mainsail (not available for carbon rigs)	○	○	4.300 €	<input type="checkbox"/>
Mast step	○	○	650 €	<input type="checkbox"/>
Elvström Duratech Dacron (HD) mainsail & self-tacking jib	○	—	5.650 €	<input type="checkbox"/>
Elvström mainsail & self-tacking jib - Sporttech triradial laminate instead of standard	○	○	6.200 €	<input type="checkbox"/>
Elvström mainsail & self-tacking jib - EPEX high performance membrane instead of standard	—	○	19.750 €	<input type="checkbox"/>
Elvström genoa 106% - Cruisetech Dacron (only with genoa tracks)	○	○	3.900 €	<input type="checkbox"/>
Elvström genoa 106% - Duratech Dacron (HD) (only with genoa tracks)	○	—	4.950 €	<input type="checkbox"/>
Elvström genoa 106% - Sporttech triradial laminate (only with genoa tracks)	○	○	6.950 €	<input type="checkbox"/>
Elvström genoa 106% - EPEX high performance membrane (only with genoa tracks)	—	○	12.750 €	<input type="checkbox"/>
Genoa tracks with pin stop cars	○	○	1.600 €	<input type="checkbox"/>
Fully battened mainsail with MDS-system, incl. 2 reefs, offshore-quality (replacing standard mainsail)	○	○	1.100 €	<input type="checkbox"/>
Elvström gennaker incl. snuffer and gennaker gear (halyard, sheets, blocks, halyard clutch and pad eye)	○	○	7.950 €	<input type="checkbox"/>
Elvström code 0 incl. Selden CX furling system and gear (halyard, sheets, blocks, halyard clutch and pad eye for code 0 tack / only with bowsprit)	○	○	7.950 €	<input type="checkbox"/>

INDIVIDUAL OPTIONS	HOLIDAY	STYLE	Price excl. VAT	C50
<b>Standing &amp; Running Gear</b>				
Lazy bag with lazy jacks for mainsail (according to BAVARIA Style guide)	○	○	1.550 €	<input type="checkbox"/>
Spreader lights, 4 pcs.	—	○	1.450 €	<input type="checkbox"/>
GRP bowsprit (black or white / recommended for gennaker and code 0)	—	○	3.200 €	<input type="checkbox"/>
<b>Winches</b>				
2 x halyard winches, size 55, electrical	○	○	5.950 €	<input type="checkbox"/>
2 x genoa/gennaker/code 0 winches, size 55, manual	○	○	2.950 €	<input type="checkbox"/>
2 x genoa/gennaker/code 0 winches, size 55, electrical	—	○	5.950 €	<input type="checkbox"/>
<b>Interior Equipment – Water</b>				
Washing machine, 220 V (only with D3 layout)	—	○	2.750 €	<input type="checkbox"/>
Electric toilet (1x) front cabin with fresh water flush system for B1 layout	○	○	1.090 €	<input type="checkbox"/>
Electric toilet (2x) front cabin with fresh water flush system for B2 layout	○	○	2.180 €	<input type="checkbox"/>
Electric toilet (2x) aft cabin with fresh water flush system for D1 or D3 layout	○	○	2.180 €	<input type="checkbox"/>
Electric toilet (1x) aft cabin with fresh water flush system for D2 layout	○	○	1.090 €	<input type="checkbox"/>
Grey water system, totalling 244 L	○	○	2.150 €	<input type="checkbox"/>
<b>Interior Equipment – Galley</b>				
Microwave, 220 V	○	○	675 €	<input type="checkbox"/>
Dishwasher, drawer 220 V	○	○	3.150 €	<input type="checkbox"/>
Additional drawer fridge incl. Freezer unit totalling 160 L	○	○	2.990 €	<input type="checkbox"/>
Extractor hood in galley	—	○	770 €	<input type="checkbox"/> SP
<b>Interior Equipment – Fresh Air</b>				
Air conditioning 18.000 BTU, cabins (no outlet for bunkbed D2) incl. 2nd shore power (220 V / 110 V, only with generator) (not in combination with hot air heating)	○	○	12.500 €	<input type="checkbox"/>
Air conditioning 16.000 BTU, salon (incl. outlet for bunkbed D2) incl. 2nd shore power (220 V / 110 V, only with generator) (not in combination with hot air heating)	○	○	5.650 €	<input type="checkbox"/>
<b>Interior Equipment – Heating</b>				
Hot air heating, 2 x 4 kW, outlets in salon and cabins, fueling via diesel tank (not in combination with air conditioning)	○	○	7.950 €	<input type="checkbox"/>
<b>Electrical Systems 230V</b>				
230 V Inverter 2500 W [true sine wave] for shore power supply	○	○	2.900 €	<input type="checkbox"/>
110 V Inverter 2000 W [true sine wave] for shore power supply	○	○	2.900 €	<input type="checkbox"/>
Generator 6.4 kW / 8 kVA, 50 Hz, 230 V	○	○	16.900 €	<input type="checkbox"/>
Generator 6.4 kW / 8 kVA, 60 Hz, 110 V	○	○	20.150 €	<input type="checkbox"/>
Country version US/JPN	○	○	2.950 €	<input type="checkbox"/>
<b>Miscellaneous</b>				
Composite gangway incl. bag and stanchions, foldable, 230 cm	○	○	2.300 €	<input type="checkbox"/>
Fresh water dockside inlet	○	○	510 €	<input type="checkbox"/>
Cockpit tables cover	—	○	620 €	<input type="checkbox"/>
Steering wheels covers	—	○	590 €	<input type="checkbox"/>
<b>Shipment</b>				
Steel cradle for overseas transport	○	○	3.200 €	<input type="checkbox"/>
Steel cradle for overseas transport without keel	○	○	5.100 €	<input type="checkbox"/>
Shrink wrap	○	○	1.150 €	<input type="checkbox"/>

— Not available ■ Standard ○ Optional

Bavaria Yachtbau GmbH, Bavariastraße 1, D-97232 Giebelstadt, Phone +49 9334 942-0, Fax +49 9334 942-116, www.bavariayachts.com, info@bavariayachts.com

All prices are in EURO and are valid only in conjunction and at the time of ordering a new yacht ex works Giebelstadt. All measurements and weights are calculations based upon design documents. The brochure is intended for advertisement only and is not part of a contract, warranty or of any offer. We reserve the right to modify or improve our products and to change specifications without notice. We are not liable for errors and printing mistakes. Aforementioned prices are recommended sales prices for deliveries ex works within 4 months of order placement. Later deliveries are subject to invoicing according to the then valid price list.

Version: 1/2020

Valid from 1<sup>st</sup> January 2020

Publication: 1<sup>st</sup> January 2020 – The previous price list loses its validity.

Language/Taxes: English pricelist/all prices excl. VAT

