

A501

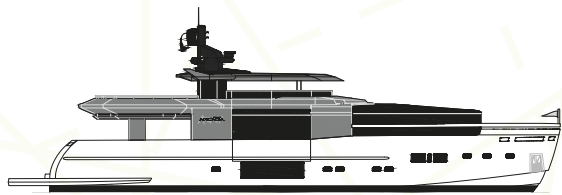

ARCADIA
YACHTS



Courtesy of
Ceramica V. Pinto
Vietri sul Mare



A RENAISSANCE OF SAILING

From a gulf that is an ancient
cradle of sailing traditions and culture,
from a land with a long tradition
of hospitality.

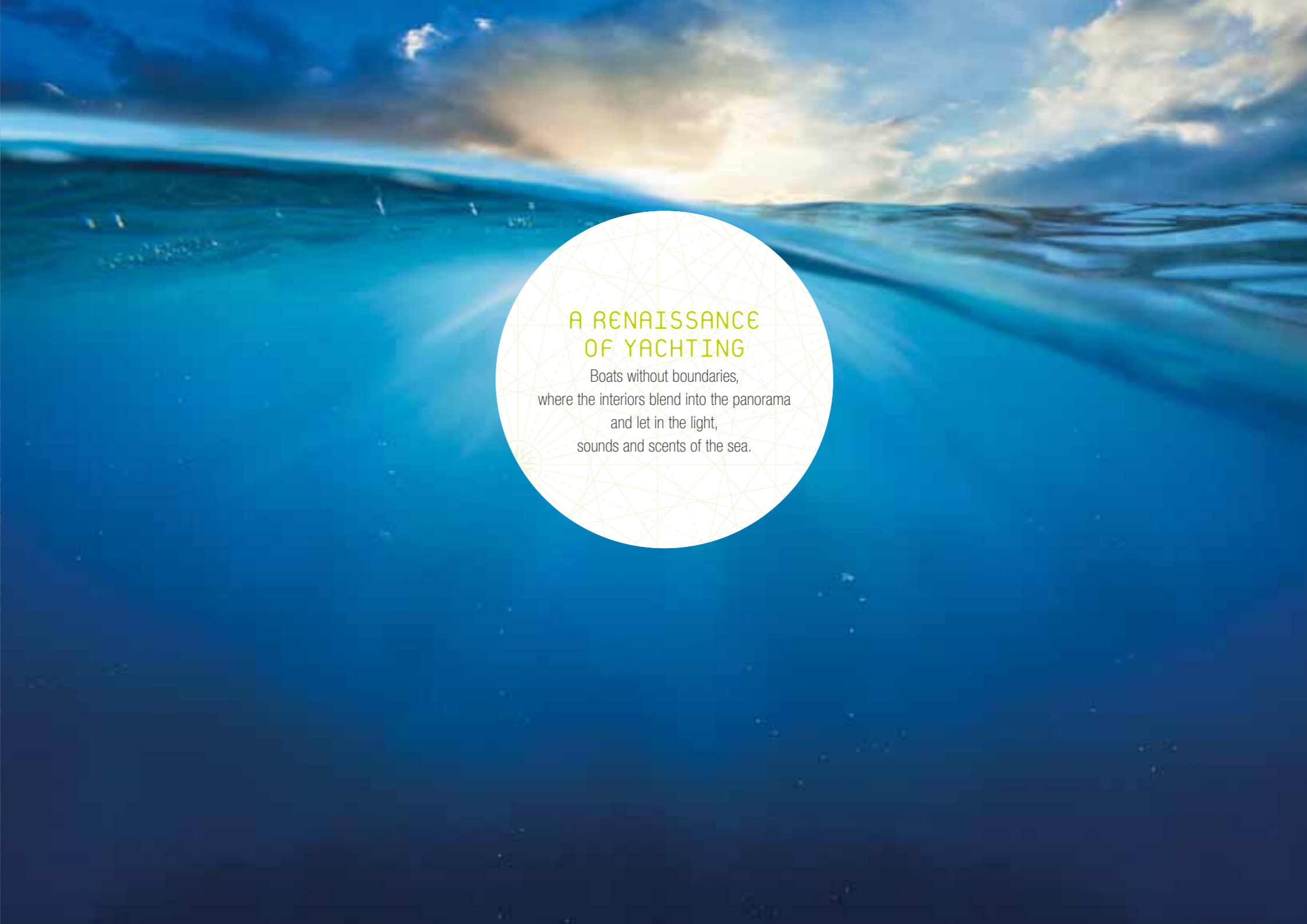

A RENAISSANCE OF YACHTING

Boats without boundaries,
where the interiors blend into the panorama
and let in the light,
sounds and scents of the sea.



**A RENAISSANCE
OF TECHNOLOGY**
More respect for nature, more comfort
living together, more sensitivity
to rediscover the sea.



**A RENAISSANCE
OF THE HUMAN BEING**
In the midst of a new voyage,
on a course taking us
farther than ever before,
surrounded by wonders.



OUR HERITAGE

ARCADIA YACHTS

identifies with the values of a culture
thousands of years old, a culture that has made its mark
on history, art and architecture, characterised
by a love of beauty and good taste and by the joy of sharing.
From ancient Pompeii to the Maritime Republic of Amalfi,
from the Neapolitan Renaissance to the city's traditional cuisine:
ARCADIA YACHTS was founded in a place
where the people cherish beauty.

A105

Design built on flexibility and seamlessness between interior and exterior spaces, with the utmost respect for the environment.















Main Deck RJ



Main Salon Sea Coral 2



Main Salon Sea Coral 2



Main Salon RJ



Multipurpose Room



Side Walk

Bow Area Sea Coral 2

LOWER DECK



Master Quarter Sea Coral 2





Owner Bathroom Sea Coral 2



Vip Cabin Sea Coral 2



Vip Bathroom Sea Coral 2



Vip Bathroom RJ

Vip Cabin RJ





Sky Lounge Sea Coral 2



Wheel House



Sun Lounge Sea Coral 2



Sun Lounge RJ





Laundry Area

Crew Quarter



Engine Room

UNIQUE
FEATURES



SEAMLESS
EXPERIENCE

Glass walls between the aft-deck and main salon and openable floor-to-ceiling windows create a fluid indoor-outdoor space for contact with nature.



**FLEXIBLE
LAYOUT**

Games room, dining room,
private lounge, master stateroom:
a range of options for the foredeck
that can be configured
to meet the owner's needs.



MAIN SALON

One-of-a-kind, with sliding
floor-to-ceiling panoramic windows
and retractable terraces,
each one about 5 metres long,
bringing the sea "inside".



CONVERTIBLE SKY LOUNGE

Up & down openable windows for the upper deck. A fully enclosed third deck protected against bad weather or open to the sky to enjoy the breeze and the scents of the sea.



PRIVATE SUN LOUNGE

A 36-square-metre area that can be easily adapted to the owner's requirements. The crew operations area is kept separate for total privacy.



SEMI-PLANING HULL

The hull is optimised to ensure a cruising speed of 12-14 knots, utmost comfort and low consumption, up to 30% less than those of other main players.



SOLAR PANELS

More than 50 square metres of solar panels that can generate more than 4 kW of power, combining the ultimate pleasure of life on-board with full respect for the environment.

GENERAL ARRANGEMENTS AND MAIN DATA

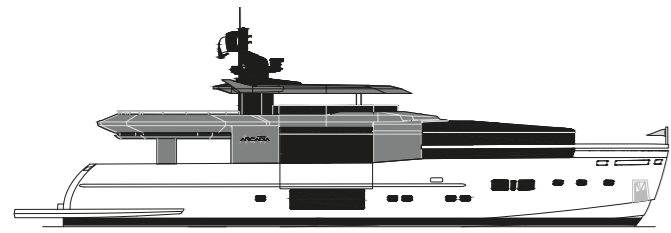

A105

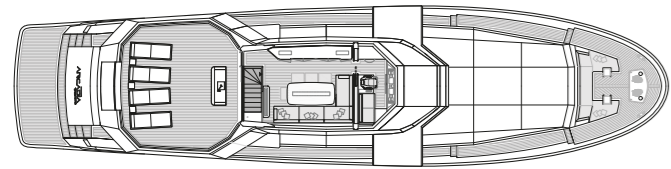

SKY LOUNGE DECK

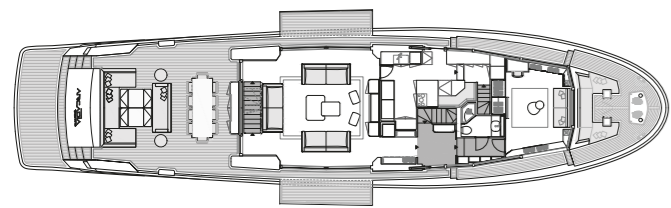

MAIN DECK

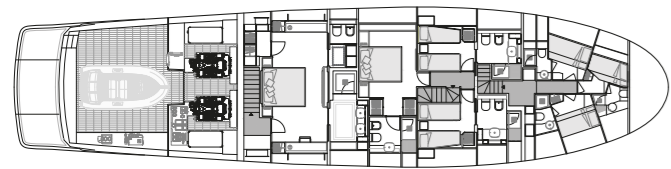

LOWER DECK

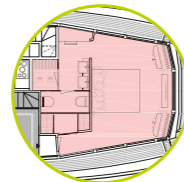

MAIN DECK
Master-quarter up
Optional version



LOWER DECK
5 Cabins
Optional version

HULL	SEMI-PLANING
HULL & MAIN DECK CONSTRUCTION MATERIAL	FIBERGLASS
VERANDAS CONSTRUCTION MATERIAL	ALUMINIUM
OVERALL LENGTH	31,57 m / 103'07"
HULL LENGTH	29,32 m / 96'02"
WATERLINE LENGHT	27,81 m / 91'03"
MAXIMUM BEAM	7,76 m / 25'06"
MAXIMUM DRAFT	2,16 m / 7'01"
DISPLACEMENT UNDER FULL LOAD	145 tons / 320.000 lb
GROSS TONNAGE	199 GT
MAIN ENGINES	2x MAN V8-1.000 hp
MAXIMUM SPEED	± 16,5 kn
CRUISE SPEED	± 14,5 kn
GENERATOR (MED / TROPICAL version)	2x 45 kW - 50 Hz / 55 kW - 60 Hz
AIR CONDITIONING (MED / TROPICAL version)	216.000 Btu/h / 240.000 Btu/h
SOLAR CELLS ENERGY	± 4,4 kW
GUEST BEDS	8 beds in 4 cabins
CREW BEDS	5 beds in 3 cabins
TANKS CAPACITY	
FUEL	15.600 l - 4.120 gal
WATER	2.800 l - 740 gal
GREY WATER	600 l - 160 gal
SEWAGE = BLACK WATER	600 l - 160 gal
INTERIOR AND EXTERIOR DESIGN IN COLLABORATION WITH	HOT LAB AND ALAIN PERRIER

OUR FLEET ARCHITECTURE

Our fleet has evolved in response to the highly divergent needs of experienced yacht owners and sailors to include vessels ranging from 18 to 35 metres, divided into two series, each with its own unique personality. A Renaissance on board, a new way to live the sea.

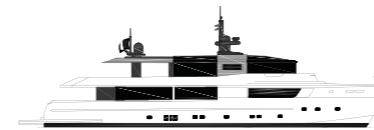

A115



A105

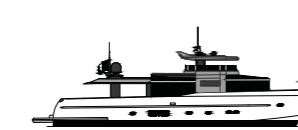

A85s

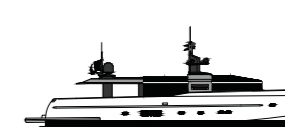

A85

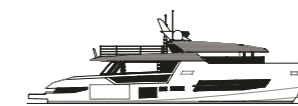

sherpa XL

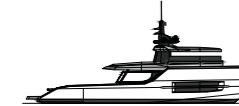

sherpa

sherpa THE POCKET-SIZED MEGA YACHT

Comfortable, agile, with options for customisation and expansive open spaces.

A THE SYNTHESIS OF A PARADOX

The thin boundary between inside and outside, between sociability and privacy.

Tender and toys are not included in standard configuration and price.
The information contained in this data sheet are not binding. For updated materials, please contact the shipyard or your Brand Rep.



OUR SHIPYARD

Every renaissance begins in a specific location. The ARCADIA YACHTS renaissance begins in its shipyard, the centre of Arcadia's design and shipbuilding work, where it all happens: from the lamination of hulls and fibreglass to woodworking and finishing.

An advanced, energy-efficient facility extending over a 47,000 sqm area in the Gulf of Sorrento, a renowned centre of shipbuilding. Since ever.



What really counts at sea
is knowing where you are
and which direction
you are heading in:
ARCADIA YACHTS has set its course
for the future, with the sailors
of today and tomorrow.



ARCADIA AWARDS



This brochure in no way constitutes a contract of sale for the boatyard's vessels to any person or company.

All information contained herein, including but not limited to technical and performance data, illustrations, and drawings, is non-binding and for purposes of illustration only.

The information in this brochure refers to the boatyard's standard motoryacht models available as of the date of publication.

Technical and descriptive information is valid only to the extent that it pertains to the specific vessel that is the subject of a purchase.

Contract terms are valid only to the extent that they are contained in a contract of sale.

This document is based on information available at the time of publication.

Despite efforts to ensure the greatest possible accuracy, the information contained herein may fail to cover all details, omit technical or commercial changes that may have been made subsequent to publication, describe features that are not present, and fail to envisage all circumstances that might occur.

Any illustrations, photographs, diagrams and examples shown in this brochure are included solely for the purposes of illustrating the text.

Due to the different features of each vessel, the boatyard assumes no liability for actual use based on the illustrated applications.

Printed December 2019

