

sherpa XL



Courtesy of
Ceramica V. Pinto
Vietri sul Mare



A RENAISSANCE OF SAILING

From a gulf that is an ancient cradle
of sailing traditions and culture,
from a land with a long tradition of hospitality.



A RENAISSANCE OF YACHTING

Boats without boundaries, where the interiors
blend into the panorama and let in the light,
sounds and scents of the sea.



A RENAISSANCE OF TECHNOLOGY

More respect for nature, more comfort
living together, more sensitivity
to rediscover the sea.



A RENAISSANCE OF THE HUMAN BEING

In the midst of a new voyage,
on a course taking us farther than ever
before, surrounded by wonders.



OUR HERITAGE

ARCADIA YACHTS identifies with the values of a culture thousands of years old, a culture that has made its mark on history, art and architecture, characterised by a love of beauty and good taste and by the joy of sharing. From ancient Pompeii to the Maritime Republic of Amalfi, from the Neapolitan Renaissance to the city's traditional cuisine: ARCADIA YACHTS was founded in a place where the people cherish beauty.

sherpa xl

New dimensions in yachting. An agile pocket-megayacht developed to offer unexpected space to enjoy life on board, thanks to its unique features.























CONVERTIBLE
SKY-LOUNGE





Closed Galley



SKY-LOUNGE
OPEN SPACE
SOLUTION









SUN-LOUNGE



LOWER DECK



Master Quarter



Owner Bathroom



Vip Cabin



Vip Bathroom



Twin Cabin

Twin Bathroom



Crew Cabin



Engine Room

UNIQUE
FEATURES



A 65 SQM WATER-SKIMMING
TERRACE AND PATIO ON THE SEA

SUN-LOUNGE

36 sqm of privacy for the owners and their guests.





CONVERTIBLE SKY-LOUNGE

The Up&Down windows transform the sky-lounge into an open or covered deck according to the wishes of yacht owners and their guests.



SOLAR PANELS

Approx. 35 sqm of state-of-the-art solar panels generate approximately 3.5 kW for all the main hotellerie services.



SYNERGY OF TECHNOLOGIES

State-of-the-art semi-planing hull and IPS propulsion system combine a top speed in excess of 23 knots and a maximum fuel efficiency (-40% vs 85-90ft players) and range (over 1.000nm) at 12 knots.



SIDE GARAGE

To host a 4mt tender and all the desired water-toys. Ensuring maximum elegance on board and cleanliness of lines.

GENERAL ARRANGEMENTS AND MAIN DATA



sherpa XL

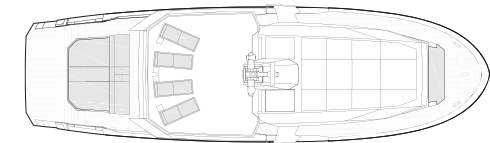

SUN DECK
Standard version

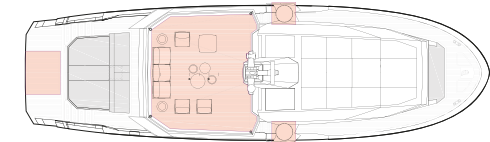

SUN DECK
Main optional available

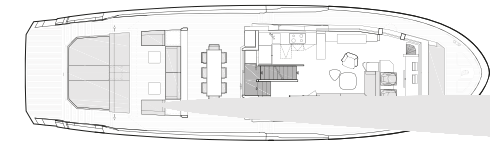

MAIN DECK
4 cabins standard version

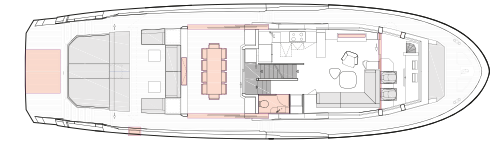

MAIN DECK
4 cabins
main optional available



LOWER DECK
4 cabins version
main optional available

**The 3 cabins version
and further solutions
are available upon request**

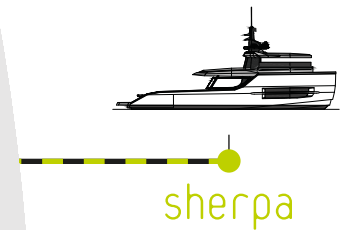
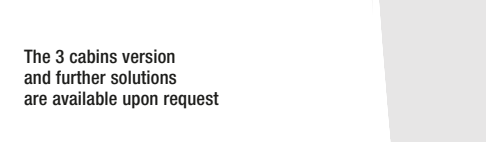
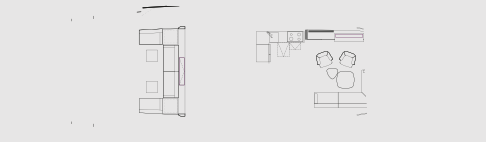
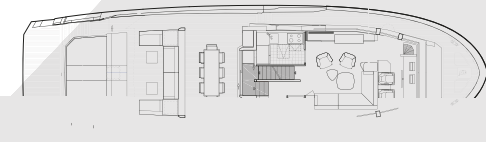

sherpa THE POCKET-SIZED MEGA YACHT

Comfortable, agile, with options for customisation and expansive open spaces.

Tender and toys are not included in standard configuration and price.
The information contained in this data sheet are not binding. For updated materials, please contact the shipyard or your Brand Rep.



OUR SHIPYARD

Every renaissance begins in a specific location.

The ARCADIA YACHTS renaissance begins in its shipyard, the centre of Arcadia's design and shipbuilding work, where it all happens: from the lamination of hulls and fibreglass to woodworking and finishing. An advanced, energy-efficient facility extending over a 36,000 sqm area in the Gulf of Sorrento, a renowned centre of shipbuilding. Since ever.



What really counts at sea
is knowing where you are
and which direction
you are heading in:
ARCADIA YACHTS has set its course
for the future, with the sailors
of today and tomorrow.



ARCADIA AWARDS



This brochure in no way constitutes a contract of sale for the boatyard's vessels to any person or company.

All information contained herein, including but not limited to technical and performance data, illustrations, and drawings, is non-binding and for purposes of illustration only.

The information in this brochure refers to the boatyard's standard motoryacht models available as of the date of publication.

Technical and descriptive information is valid only to the extent that it pertains to the specific vessel that is the subject of a purchase.

Contract terms are valid only to the extent that they are contained in a contract of sale.

This document is based on information available at the time of publication.

Despite efforts to ensure the greatest possible accuracy, the information contained herein may fail to cover all details, omit technical or commercial changes that may have been made subsequent to publication, describe features that are not present, and fail to envisage all circumstances that might occur.

Any illustrations, photographs, diagrams and examples shown in this brochure are included solely for the purposes of illustrating the text.

Due to the different features of each vessel, the boatyard assumes no liability for actual use based on the illustrated applications.

